



Create a Virtual Classroom Manager

Login to Moodle using your Fed Uni username and password.

LOG IN

Username:

Password:

Remember username

LOG IN

Forgotten your username or password?
Cookies must be enabled in your browser 

Inside your selected course, ensure you have turned editing on



Click **Add activity or resource** and select **Adobe Connect**.

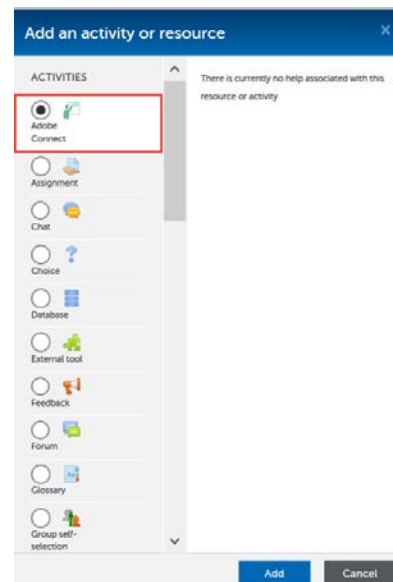

Give the link a name (eg. Virtual Learning Space) this is the name of the link the students will use access the virtual classroom and virtual office.

Activity name 

Click **Save and return to course**



Tip: We recommend you place the link to your Virtual Learning Space in the Topic 0